

37 Shamal



Windy
SPIRIT OF SCANDINAVIA

With modern retro-styling the new Windy 37 Shamal is set to emulate the success of the legendary Khamsin.

Designed by the internationally acclaimed yacht designer Espen Øino and steeped in Windy's core DNA, the Shamal celebrates "ease of use boating", in 21st century style and grand comfort. With its focus on a spacious cockpit, superb hull and excellent handling, we are proud to announce the launch of a pure Windy Sportsboat.

Inspired by the Windy models built in the Sixties and Seventies, Espen Øino and his team have developed a fantastic design language with high comfort and technology brought right up to date.



Espen Øino, world-renowned designer, founded his technical and design office specializing in yacht design, naval architecture and engineering related disciplines in Monaco.

This Norwegian-born designer linked his destiny with the yachting industry very early on in life: he drew his first boat at the age of two and has been obsessed with boat design ever since.

The company, Espen Oeino International, has left a significant imprint on the new build market and is today considered one of the world's leading design studios for bespoke motor yachts.



Conceived primarily as a dayboat, the Windy 37 Shamal has a spacious two cabin arrangement.

There is a large forward cabin with a double bed and a roomy center cabin with twin beds.

The 37 Shamal's deep, safe cockpit is both social and versatile. It has a large aft sun pad with a movable backrest and it can be easily protected by her canopy system or bimini top.

As such, the 37 Shamal will appeal to discerning boat enthusiasts in all markets, from the short but sweet summers of Scandinavia, to the cool lakes of Switzerland and the hotspots of the Mediterranean.



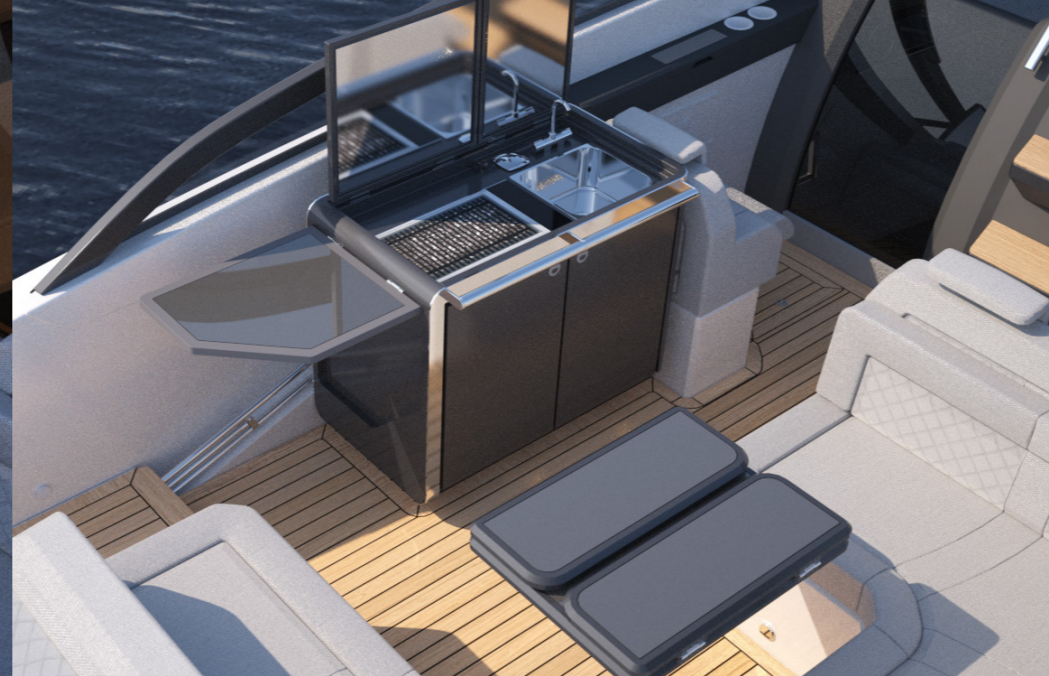
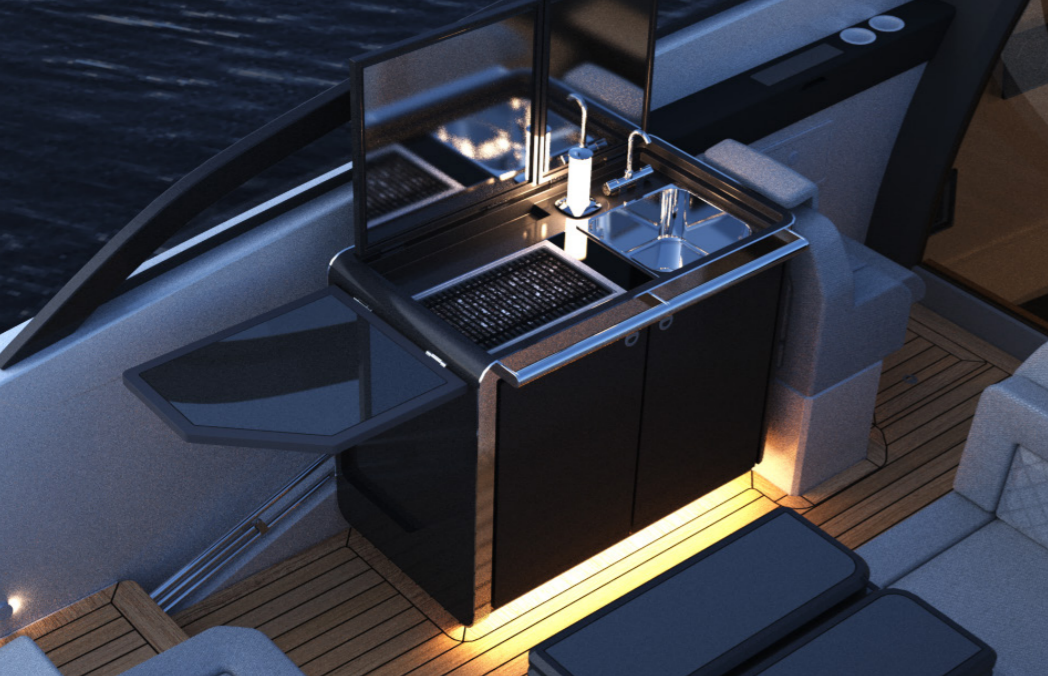

GENERAL DIMENSIONS & CAPACITIES

• Length overall	10,64 m / 11,25 m
• Beam	3,33 m
• Height	2,82 m
• Weight	Approx. 7500 kg (incl. Engines)
• Fuel	650 liters
• Fresh water	200 liters
• Berths	4
• CE Classification	RCD Category B
• Exterior design and styling:	Espen Øino International
• Interior design	Espen Øino International
• Naval Architect	Espen Øino International / Meyer Norschau Design

PRELIMINARY LIST OF STANDARD EQUIPMENT

DECK FITTINGS & EQUIPMENT

- Stainless deck cleats x 6
- Pulpit and rails in stainless steel
- Stainless anchor bow roller
- Stainless Bruce anchor (15 kg). 34m galvanized chain
- Reversible anchor winch, operated from deck or helm
- Anchor chain lockers
- Fender storage
- Decksideside fresh water filler
- Decksideside discharge-point for holding tank
- Flag pole and ensign socket
- Signal horn
- Double curved safety glass windscreen with stainless steel grabrails
- Access to foredeck through center of windscreen
- Navigation lights

HELMSMAN'S AND CO-PILOTS POSITIONS

- Helm position bridge with pilot and co-pilot chairs
- Windscreen wiper
- Windscreen washer
- Single electronic lever engine controls
- Switch panel for all service functions
- USB socket/port
- Glass holders
- Fuel shut-off handles
- Fusion Apollo radio with Bluetooth and DAB
- 4x FUSION speakers
- Nextel antiglare surface on dashboard
- Demisting / Defroster system
- Steering wheel upgrade to Sport version
- Electronic steering (only with Diesel motorisation)
- Chartplotter 1x Axiom 16
- Engine data Interface

ELECTRICAL EQUIPMENT

- 12 volt electrical system
- 2x Engine and 2x Domestic AGM batteries
- Full digital engine intergration with plotter
- Hot water tank (40 L) heated by engines / 230V
- Holding tank w/ electric pump
- Windscreen wipers
- Windscreen washer
- Horn
- Bilge pumps, electrical and manual
- Shower drain pump
- Navigation lights
- Switch panel and circuit breakers
- Fire Suppression System in engine room

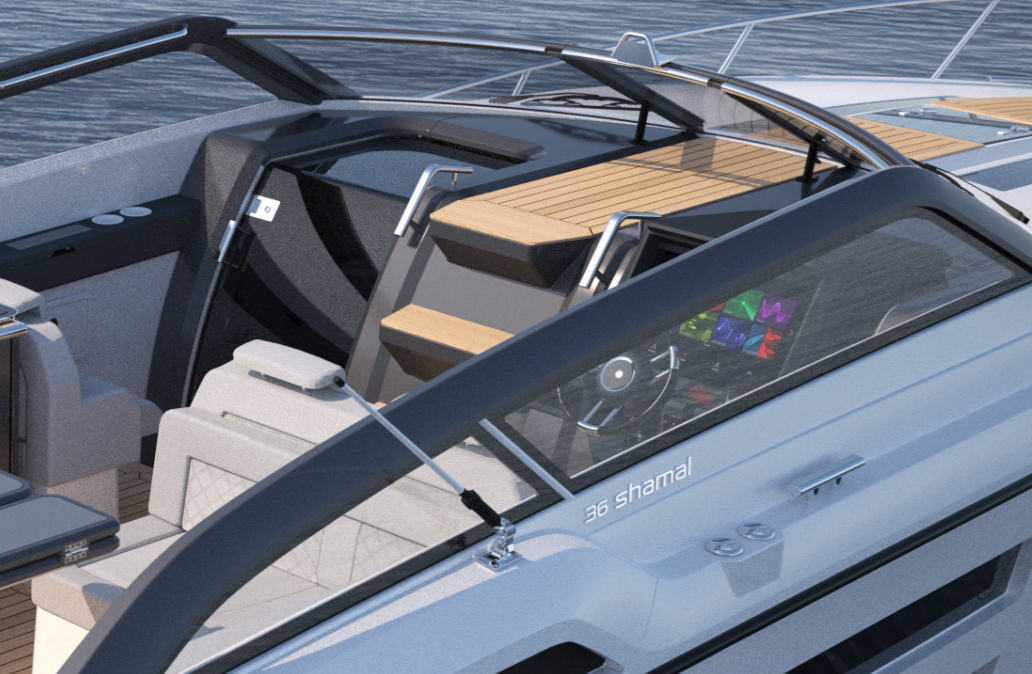

COCKPIT

- Self-bailing cockpit
- Comfortable seating for 7 persons
- Storage under cockpit sofa and co-pilot seat
- Handcrafted cockpit table
- Full canopy in lightweight (light grey) material
- Electrically operated canopy tightening system
- Main switch and circuit breaker panel
- Hand- held fire extinguishers (2kg)

COCKPIT GALLEY

- Wetbar with slim design
- Sink w/ hot & cold water
- Gas cooker
- 230V socket
- Cockpit refrigerator 49L
- Drawers

AFT SUN DECK AREA

- Large sunbathing area
- Adjustable backrest for sun lounge configuration
- Storage compartment
- Stainless steel rail
- Shower on platform with hot & cold water.
- 230V Shore-power connection (incl. cable)

FORWARD CABIN

- Double berth with high-quality spring mattress
- Drawer under double berth
- Skillfully crafted woodwork
- Overhead lockers
- Exclusive high quality floor
- Reading lights (2)
- Overhead downlights
- 230V / USB socket
- Blinds
- Indirect LED lights
- Skylight hatch with integrated mosquito net and night screen
- Hand- held fire extinguishers (2kg)

GUEST CABIN

- Double berth with high-quality spring mattresses
- Bedside storage
- Skillfully crafted interior woodwork
- Overhead locker
- Exclusive wooden floor
- Reading lights (2)
- Overhead downlights
- Openable ventilation window
- Indirect LED lights
- Blinds
- 230V / USB socket

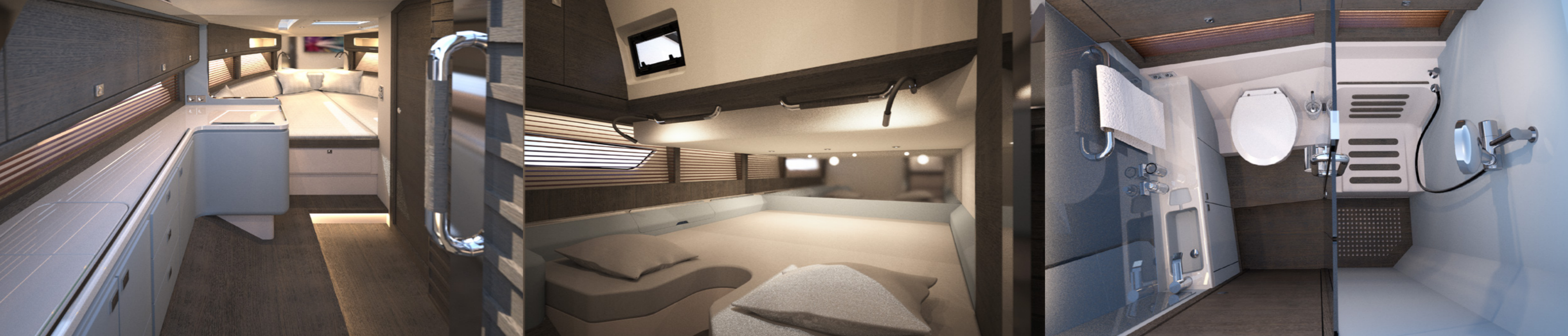

SHOWER AND HEADS

- Counter top in high-grade composite material
- Wash basin with hot and cold water and accessories
- Electric toilet
- Separate shower compartment
- Teak grating on shower floor
- Glass holder
- Towel hangers
- Skillfully crafted interior woodwork
- Overhead lockers
- Bathroom cupboard
- Mirror
- Overhead LED striplights
- Blinds
- Extractor fan
- 230V socket for shaver or hair dryer
- Indirect LED light in niche

BELOW DECK AND SERVICE GALLEY

- Exclusive high quality floor
- Overhead cupboard with Micro-oven
- Drawers for storage
- Overhead LED striplights
- Indirect lights companion way
- Indirect lights lower pantry
- Dimmer for overhead LED spotlights
- Galley top in high-grade composite material
- Drawers for storage
- 2x 230V / 1x USB socket
- Cutting board

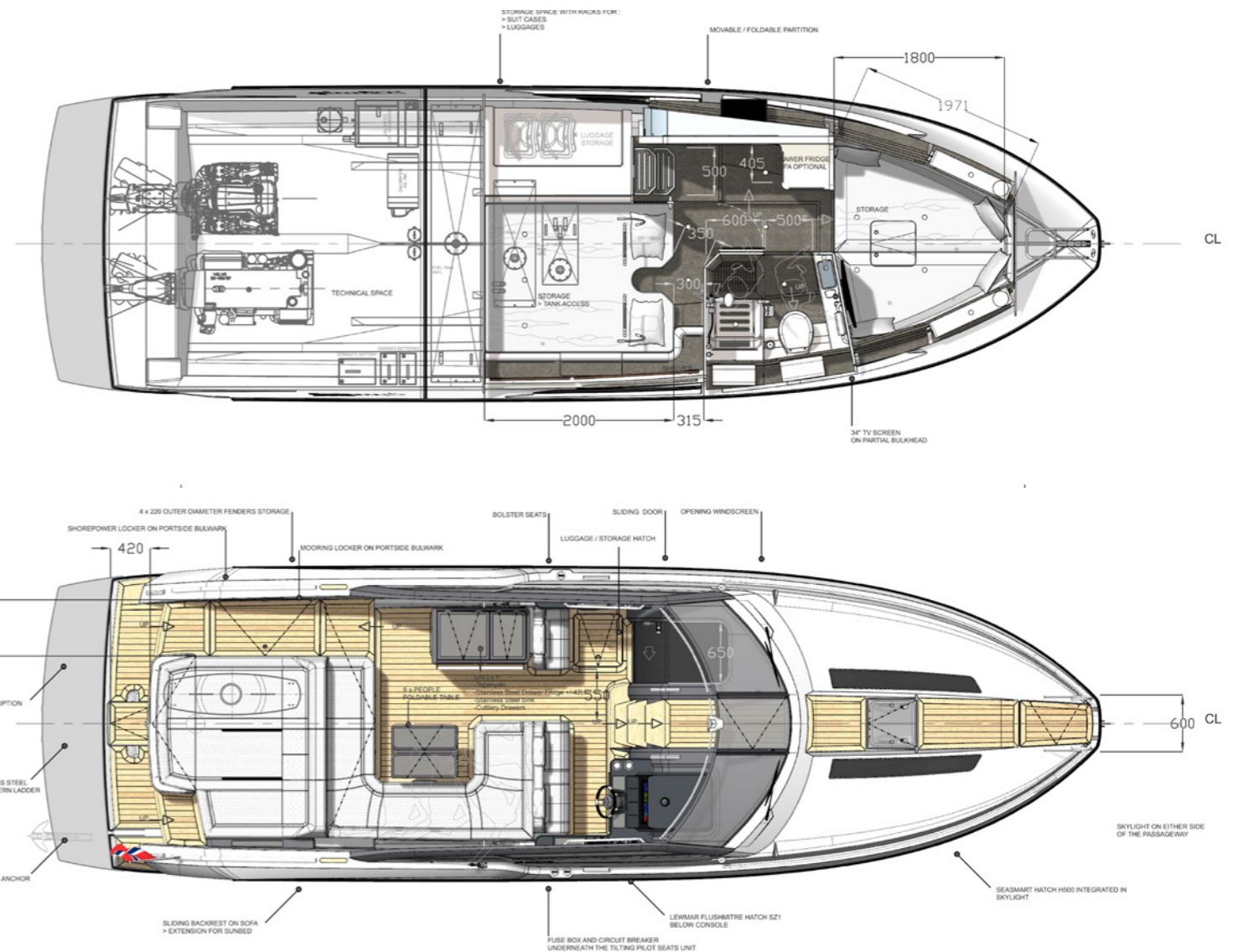

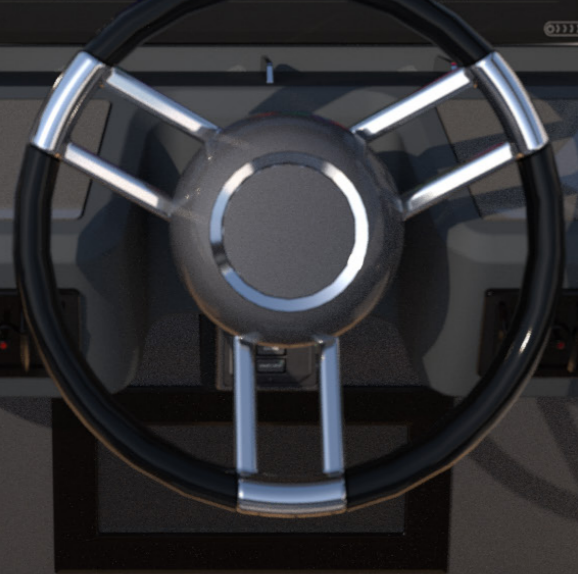
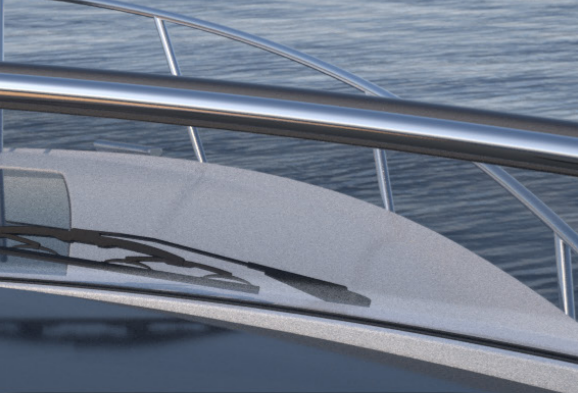
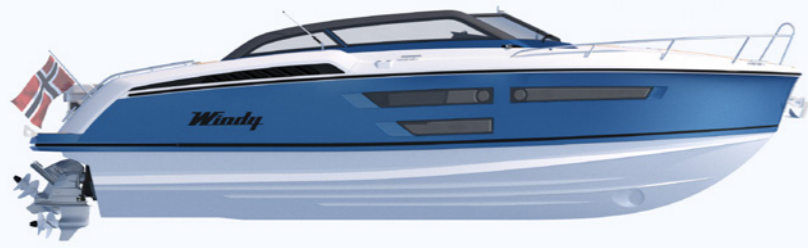

37 Shamal



Windy
SPIRIT OF SCANDINAVIA

WINDY SCANDINAVIA AB · SÖDRA VARVSGATAN 27 · 593 50 VÄSTERVIK · SWEDEN
contact@windyboats.com · www.windyboats.com